

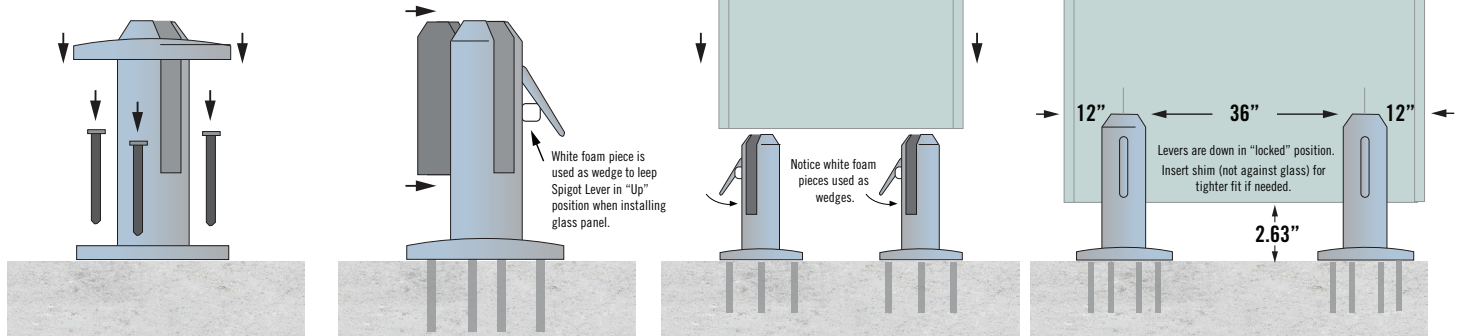

# INSTALLATION WITH TWO OR THREE CVGR LEVER SPIGOTS

## 2 LEVER SPIGOT INSTALLATION

Will Withstand Wind Gusts up to 115 MPH



## 3 LEVER SPIGOT INSTALLATION

Will Withstand Hurricane Force Winds

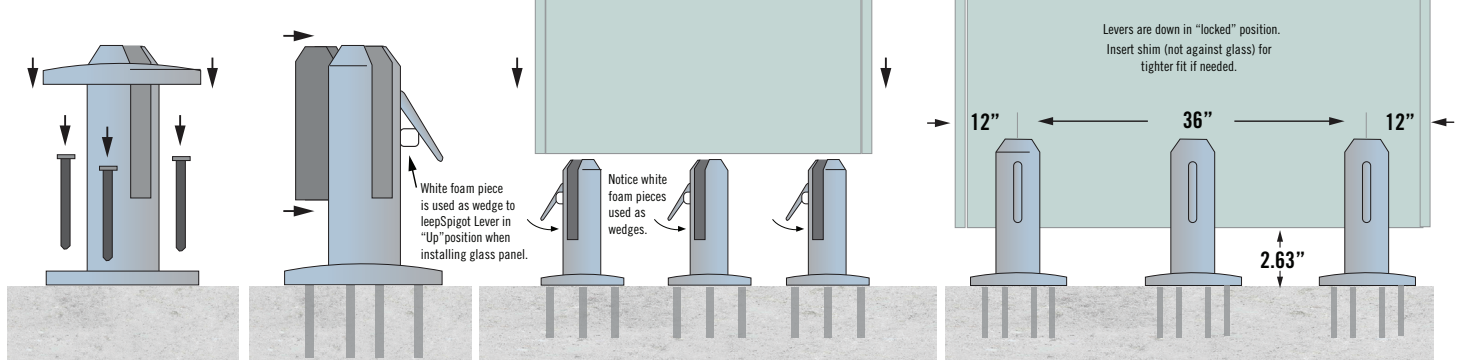

## Wood Deck Installation

We suggest using 3/8" diameter x 3.5" ASTM A307 Grade A structural bolts and flat washer. ASTM A307 Grade A structural bolts and washer should be cadmium plated or stainless steel so they do not rust.

Lag bolts must be installed into rim joists or lam beam or properly blocked sub structure. If lag bolts are attached to deck planks only failure will occur as a result of improper installation. Improper installation and failure may result in injuries or death. Do it once and do it right!

## Installation of Spigots Using Wood Planks

Installation of ClearView Glass Railings® Spigots to wood planks are fine as long as you use three 2" x 10"s. You must tie the three plies of wood together with (4) #8 4" wood screws, located 3" from spigot screws.

More installation information including additional fastener product recommendation listed on next page. Product Specifications included as well.

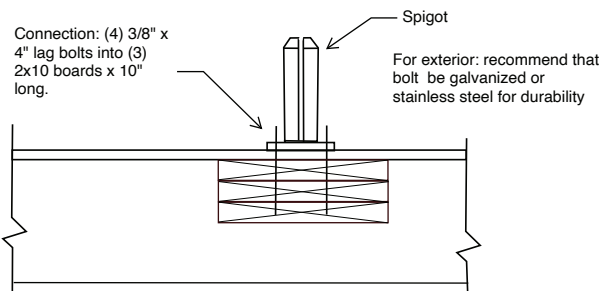



## Fastener Recommendation (Fasteners by others)

We recommend RSS Rugged Structural Screws by GRK Fasteners (product image shown).

**This product is available at Home Depot:**

- Internet #203525067
- Model #112225
- Store SKU #518167

## Installation Tips

- Mark spigot location on glass panels with a crayon or wax marker. This allows for fast and easier installation of panel in proper location.

## • VERY IMPORTANT •

- Apply a bit of lubricant (petroleum jelly) to the inside of the spigot's black plastic boot where the boot meets the glass. The application of lubrication prevents the spigot's black plastic boot from grabbing the glass panel should you slide/move the glass to adjust its position while in the spigots.
- Once glass is in place, you can check for fit by pulling up on glass panel. If glass is not tight in Lever Spigot with lever closed, open lever and install the 0.2mm shim (provided) between the plastic boot and the inside of the Lever Spigot. **DO NOT PLACE SHIM AGAINST GLASS PANEL.**
- Do not attempt to slide the glass panel while it is in the spigot if there is no lubricant on the black plastic spigot boot as the glass panel may stick and fail.
- If no lubrication is applied to the spigot boot, you must lift the glass panel out of the spigot, adjust its position as desired and then lower the glass panel back into the spigot.

### GENERAL NOTES:

**1.** THIS GUARDRAIL SYSTEM IS IN COMPLIANCE WITH THE 2014 AND 2017 INTERNATIONAL BUILDING CODE (IBC) SECTION 1607.8. IT IS ALSO IN ACCORDANCE WITH 2015 IBC SECTION 2407 THAT REQUIRES ALL-GLASS HANDRAILS AND GUARDS BE "LAMINATED GLASS CONSTRUCTED OF FULLY TEMPERED OR HEAT-TREATED GLASS". **2.** CONNECTION TO DECK SHOWN (4) 3/8" LAG BOLTS THROUGH DECK TO (3) 2X10 BOARDS, MEETS IBC DECK REQUIREMENTS FOR A 200 POUND POINT LOAD OR 50 POUND LINE LOAD AT ANY PLACE ON PANEL. LOADING TO BE EITHER VERTICAL OR HORIZONTAL BUT NOT SIMULTANEOUS. **3.** WHEN THREE SPIGOTS ARE USED, THIS PRODUCT COMPLIES WITH THE REQUIREMENTS FOR HIGH VELOCITY HURRICANE ZONES (HVHZ). **4.** SPIGOTS TO BE 316 STAINLESS STEEL. **5.** CONNECTION TO BUILDING VARIES BY PROJECT, TO BE DESIGNED BY PROJECT ENGINEER. **6.** THE ABILITY OF THE EXISTING HOST STRUCTURE TO SAFELY SUPPORT THE LOADS SHALL BE DETERMINED BY THE PROJECT ENGINEER. **7.** MECHANICAL FASTENERS, AS SHOWN **8.** FASTENERS BY OTHERS.

## Specifications



<b>Part Number</b>	CVGR Duplex 2205 Stainless Steel Satin Finish
<b>Product Name</b>	Round Deck Mount Spigot
<b>Spigot Size</b>	1.9" diameter x 7.1" tall
<b>Spigot Weight</b>	5.5 lbs.
<b>Glass Thickness/ Dims/Weight (per panel)</b>	13.1mm/ 60" width x 39.37" height/105 lbs.
<b>Accessories Included</b>	Base Cover, Plastic and Metal Spigot Boot, One 0.2mm Metal Shim

(Fasteners by others)

# CVGR Lever Spigot Attachment to Wood Deck (additional instructions)

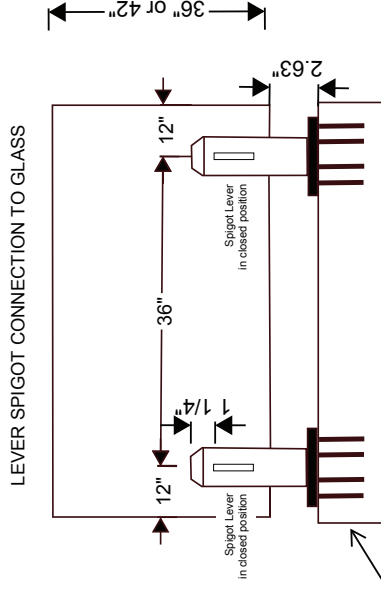
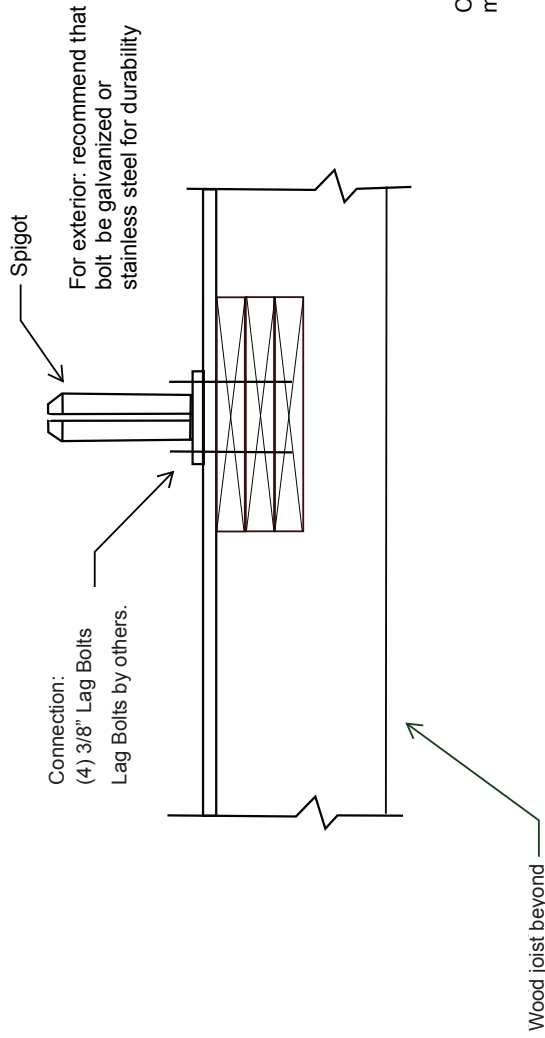

NOTE: Panels in high wind coastal areas require three spigot, all other areas require two.

Connection to base material varies.

## GENERAL NOTES:

1. CONNECTION TO DECK SHOWN (4) 3/8" LAG BOLTS THROUGH DECK TO (3) 2X10 BOARDS. MEETS IBC DECK REQUIREMENTS FOR A 200 POUND POINT LOAD OR 50 POUND LINE LOAD AT ANY PLACE ON PANEL. LOADING TO BE EITHER VERTICAL OR HORIZONTAL BUT NOT SIMULTANEOUS. FASTENERS BY OTHERS.
2. WHEN THREE SPIGOTS ARE USED, THIS PRODUCT COMPLIES WITH THE REQUIREMENTS FOR HIGH VELOCITY HURRICANE ZONES (HVHZ).
3. SPIGOTS TO BE DUPLEX 2205 STAINLESS STEEL.
4. CONNECTION TO STRUCTURE VARIES BY PROJECT. THE ABILITY OF THE EXISTING HOST STRUCTURE TO SAFELY SUPPORT THE LOADS SHALL BE DETERMINED BY THE PROJECT ENGINEER.
5. MECHANICAL FASTENERS, AS SHOWN.
6. FASTENERS BY OTHERS.

<b>Part Number</b>	CVGR Duplex 2205 Stainless Steel Satin Finish
<b>Product Name</b>	Round Deck Mount Spigot
<b>Spigot Size</b>	1.9" diameter x 7.1" tall
<b>Spigot Weight</b>	5.5 pounds
<b>Glass Thickness/ Dimensions/Weight (per panel)</b>	13.1 mm/60" wide x 39.37" tall/ 105 pounds
<b>Accessories Included</b>	Base Cover, Plastic and Metal Spigot Boot, One 0.2mm Metal Shim