

# CVGR Lever Spigot Attachment to Wood Deck

## (additional instructions)

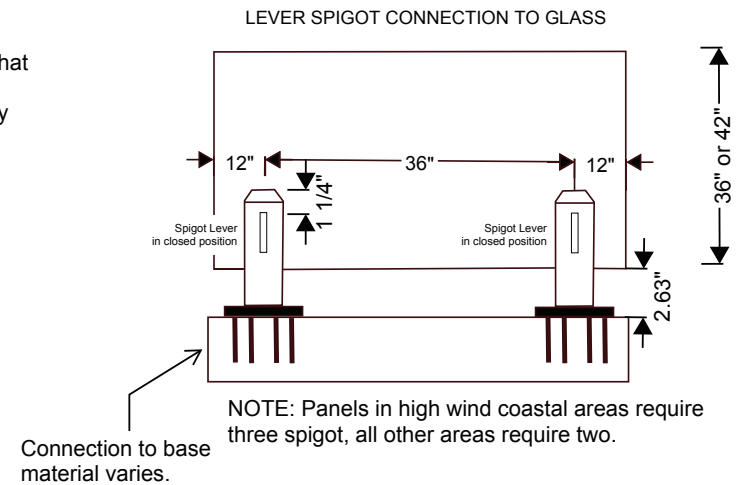
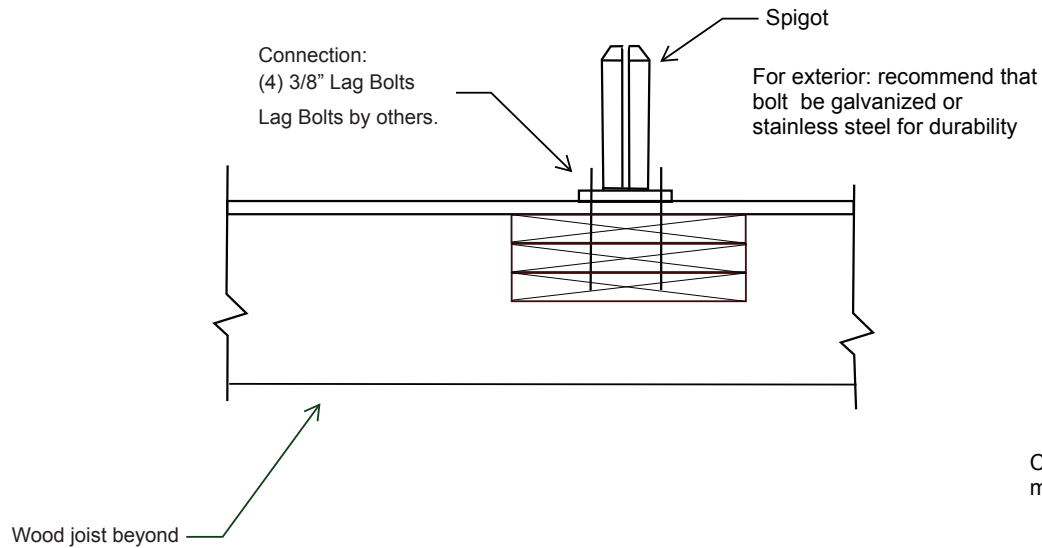

### GENERAL NOTES:

1. CONNECTION TO DECK SHOWN (4) 3/8" LAG BOLTS THROUGH DECK TO (3) 2X10 BOARDS, MEETS IBC DECK REQUIREMENTS FOR A 200 POUND POINT LOAD OR 50 POUND LINE LOAD AT ANY PLACE ON PANEL. LOADING TO BE EITHER VERTICAL OR HORIZONTAL BUT NOT SIMULTANEOUS. FASTENERS BY OTHERS.
2. WHEN THREE SPIGOTS ARE USED, THIS PRODUCT COMPLIES WITH THE REQUIREMENTS FOR HIGH VELOCITY HURRICANE ZONES (HVHZ).
3. SPIGOTS TO BE DUPLEX 2205 STAINLESS STEEL.
4. CONNECTION TO STRUCTURE VARIES BY PROJECT. THE ABILITY OF THE EXISTING HOST STRUCTURE TO SAFELY SUPPORT THE LOADS SHALL BE DETERMINED BY THE PROJECT ENGINEER.
5. MECHANICAL FASTENERS, AS SHOWN.
6. FASTENERS BY OTHERS.

<b>Part Number</b>	CVGR Duplex 2205 Stainless Steel Satin Finish
<b>Product Name</b>	Round Deck Mount Spigot
<b>Spigot Size</b>	1.9" diameter x 7.1" tall
<b>Spigot Weight</b>	5.5 pounds
<b>Glass Thickness/ Dimensions/Weight (per panel)</b>	13.1 mm/60" wide x 39.37" tall/ 105 pounds
<b>Accessories Included</b>	Base Cover, Plastic and Metal Spigot Boot, One 0.2mm Metal Shim